

AMHERST COLLEGE 2020

Landscape Master Plan

Amherst College, Amherst,
Massachusetts

Project Data

Date: 1997

Size: 110 acres

Context: Private Liberal Arts
College, Central
Massachusetts

Project Description:

Amherst College 2020 is a vision for the future of an historic 110-acre New England campus. The vision is based on a detailed assessment of campus character and identity, vehicular access, circulation and parking, the pedestrian environment, plantings and furnishings. Tasks included case study research, inventories, analyses, proposals and preparation of guidelines. Proposals for the campus include re-aligned entryways, a roadway closure, parking additions and re-locations, accessible walkways, new and improved gathering spaces and quadrangles, tree plantings, clearings and an orchard.

EDC Principal Thomas Elmore was project landscape architect while with another firm.

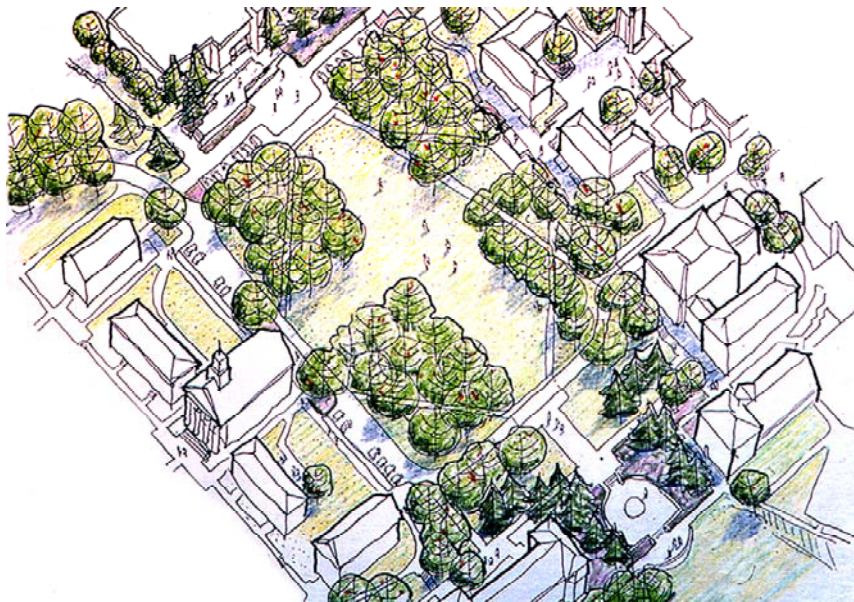

Bird's Eye View – Main Quad

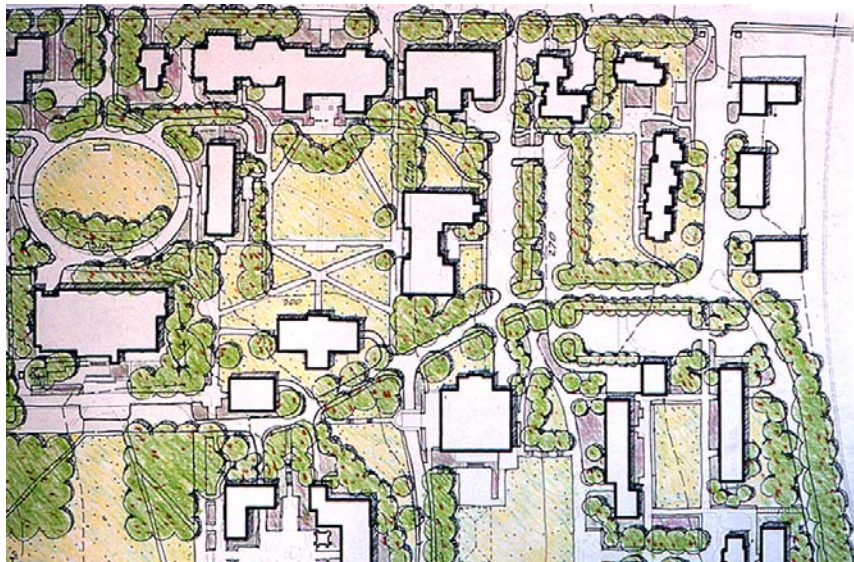

Plan View – Northeast Corner of Campus